



PBV Valves

Full Opening Swing Style Check Valves

REQUEST A QUOTE
sales@dkamans.com

SCHEDULE SERVICES
562-529-8400

WWW.DKAMANS.COM

Standard Features

- 316 SS Clapper and Pin 2", 3" & 4", WCC + 316L Overlay, Clapper 6" and Above
- 316 SS Overlay on Integral and Removable Seat Designs
- 316 SS Overlay on Body Disc Contact
- API 6D Monogrammed
- Material Meets NACE MR0175 2002
- Graphite Secondary Body Gasket for Firesafe Operation
- Dove Tail Seat/Clapper O-Ring Seal Groove
- Full Port Piggable
- Blind Bolt Holes and Metal-to-Metal Body Cover
- WCC/WCB Dual Rated Body Material
- Viton® GF Seals
- Hydrostatic Tested 100% to API 6D and API 598
- In-Line Repairable
- Bleed Plug On Cover
- Cast Feet To Prevent Roll Over (10" & Larger)
- Suitable for Horizontal & Vertical Upflow Installation

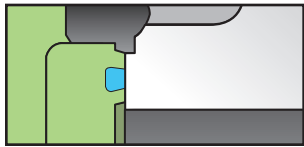

Series P800 Standard Integral Seat Design Seals With a Clapper O-ring.

How To Order

Specifying PBV® Series P800 & P900 Valve Figure Numbers

Follow the example and use the figure number chart below to specify the valve you need.

Example: 4" P-860-11-2236-YY • This number represents a 4" P Series, Integral Seat Design, Class 600, Firesafe to API 6FD, Raised Face End Connections, Carbon Steel Body & Cover, Stainless Steel Disc, Viton® GF Seals, NACE, no modifications.

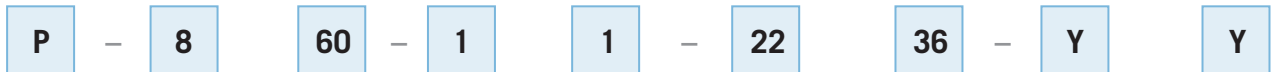

Series	Design	Pressure Class	Fire Tested	End Connection	Body/Cover Material	Trim Material	Seat Seals	Cover Seals
P PBV	8 6D Integral Seat	10 150	1 API 6FD	1 RF	22 Carbon Steel-WCC	36 Stainless Steel	B Buna N	B Buna N/Graphite
	9 6D Removable Seat	30 300		2 Non-Standard	28 LT Carbon Steel-LCC	00 Same As Body	R LT Buna N	R LT Buna N
	60 600	60 600		3 RTJ			Y Viton® GF	Y Viton® GF/Graphite
	90 900	90 900		4 RF x WE			W Viton® B	W Viton® B
	15 1500	15 1500		5 WE			AED*	AED*
	25 2500	25 2500		6 RTJ x WE				Z RTJ

Note: Other materials available upon request.
*API 6D requires AED for Class 600 and above.

Manufactured in Strict Conformance with the Following Industry Standards

- ISO 9001 Quality System
- API 6D Specification for Pipeline Valves
- ASME B16.34 Valves-Flanged, Threaded & Welding End
- ASME B16.5 Pipe Flanges & Flanged Fittings
- NACE MR0175 2002 Sulfide Stress Cracking Resistant Metallic Materials for Oilfield Equipment
- CSA #Z245.15 Steel Valves
- ASME Section VIII Division 1 Boiler & Pressure Vessel Code
- Canadian Registration Number (CRN) Products Registered in all Provinces and Territories

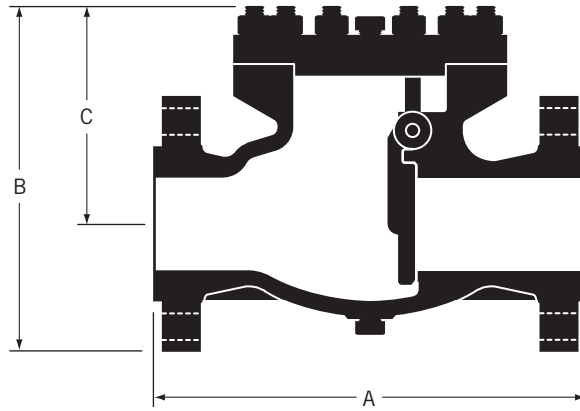

Dimensional Data • Class 150-1500, 2"- 6", (in.)

Size (in.)	ANSI Class	Wrk. Press.	A RF	A RTJ	B	C	Wt. (lbs.)
2	150	290	8	8 1/2	9	6	40
	300	750	10 1/2	11 1/8	9	6 1/2	42
	600	1500	11 1/2	11 5/8	9 1/4	6 1/2	57
	900	2250	14 1/2	14 5/8	10 1/2	8 1/2	150
	1500	3750	14 1/2	14 5/8	10 1/2	8 1/2	150
3	150	290	9 1/2	10	10 5/8	7 1/2	69
	300	750	12 1/2	13 1/8	10 5/8	9	70
	600	1500	14	14 1/8	11 3/8	8 1/4	100
	900	2250	15	15 1/8	11 3/4	9 1/2	180
	1500	3750	18 1/2	18 5/8	15 5/8	10 1/2	280
4	150	290	11 1/2	12	12 5/8	9	94
	300	750	14	14 5/8	13 1/2	10	120
	600	1500	17	17 1/8	13 3/4	10 3/4	181
	900	2250	18	18 1/8	14	11 1/2	250
	1500	3750	21 1/2	21 5/8	17	12 1/4	370
6	150	290	14	14 1/2	16 1/2	11	161
	300	750	17 1/2	18 1/8	18	12 1/2	250
	600	1500	22	22 1/8	19 5/8	14	440
	900	2250	24	24 1/8	20	15	890
	1500	3750	27 3/4	28	22	15 1/2	1040

Dimensional Data • Class 150-900, 12"- 24", (in.)

Size (in.)	ANSI Class	Wrk. Press.	A RF	A RTJ	B	C	Wt. (lbs.)
12	150	290	27 1/2	28	26 3/8	19	619
	300	750	28	28 5/8	29	20 1/2	850
	600	1500	33	33 1/8	33 7/8	22	1430
	900	2250	38	38 1/8	36	24	2370
14	150	290	31	31 1/2	24.25	16.15	1085
	300	750	33	33 5/8	27.10	16.30	1770
	600	1500	35	35 1/8	28.00	16.90	2260
16	150	290	34	34 1/2	31.50	18.90	1405
	300	750	34	34 5/8	33.40	19.50	1960
	600	1500	39	39 1/8	37.30	22.50	3035
18	150	290	38 1/2	39	37.10	22.32	1960
	300	750	38 1/2	39 1/8	37.60	22.50	2530
	600	1500	43	43 1/8	37.35	22.50	4050
20	150	290	38 1/2	39	37.92	22.95	2110
	300	750	40	40 3/4	40.71	23.62	3220
	600	1500	47	47 1/4	45.10	27.40	6120
24	150	290	51	51 1/2	47.30	28.50	3290
	300	750	53	53 7/8	47.75	28.75	4170
	600	1500	55	55 3/8	48.50	29.25	7970

Parts & Materials

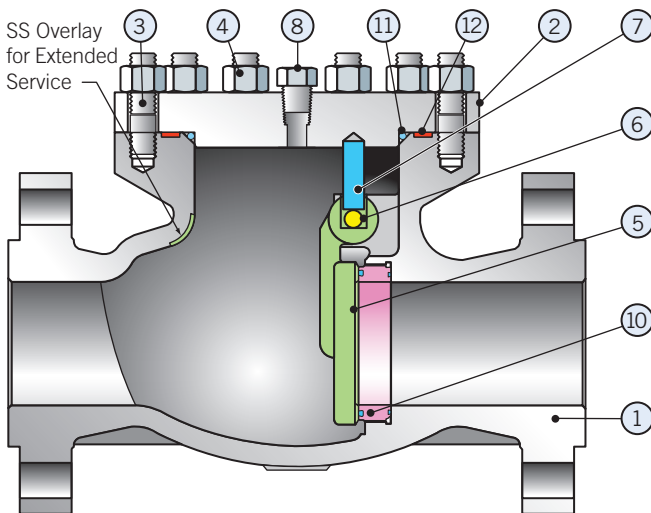

2", 3" & 4" illustration only. Parts may vary according to design.

Item No.	Description	Standard Sour (NACE) Trim
1	Body	ASTM A216 Gr. WCC
2	Cover	ASTM A516 Gr. 70/A216 Gr. WCC
3	Stud	ASTM A193 Gr. B7M
4	Nut	ASTM A194 Gr. 2HM
5	Clapper	316 SS 2", 3" & 4" ASTM A216 WCC +316L Overlay 6" & Above
6	Clapper Pin	ASTM A479 Gr. 316 SS
7	Stop Pin	ASTM A105
8	Vent Plug	ASTM A105
9*	Clapper O-Ring (Std.)	Viton® GF
10	Removable Seat (Optional)	316 SS 2", 3" & 4" ASTM A105/316 SS Overlay 6" & Above
11**	Cover O-Ring	Viton® GF
12**	Cover Gasket	Graphite

NOTE: We reserve the right to change materials and specifications.

*Not shown in illustration (left), see detail on page two.

**900 Class and larger with RTJ Gaskets.

PBV® General Terms and Conditions of Sale

By acceptance of the goods described herein, the Purchaser expressly acknowledges and agrees to the following general terms and conditions of sale (the "Terms and Conditions"):

- 1. Warranty:** The warranty described below applies only to new or unused goods or goods reconditioned by PBV® Valve (Seller). The Seller specifically disclaims any warranty for used goods or goods sold as is. For a period of one (1) year after date of shipment of any of the goods described herein, Seller warrants such goods shall remain free from failure due to defects in workmanship and materials incorporated therein by or for Seller provided such failure shall not have been caused or contributed to by improper usage, storage, service application, installation or maintenance, repairs, alterations, or modifications effected by or for the user; or misuse, negligence or accident. In the event of failure for which Seller has assumed warranty obligations hereunder, and provided Purchaser provides written notification of such failure immediately to Seller, Seller agrees to repair, or at its option, to replace the goods sold at its sole expense. Apart from the warranty and undertaking above set forth, or unless otherwise specifically consented to in writing by Seller, Seller assumes no obligation or liability for losses, expenses or damages, direct or consequential, suffered or incurred as a result of any failure of, or defect in, the goods described herein, including but not limited to, such losses, expenses or damages as may result from the necessity to remove, replace, restore or transport the goods from any location or service in which they may be used, regardless of the cause of such failure or defect. This warranty extends only to the original Purchaser of the goods and is the only warranty made by Seller in connection herewith; provided, however, that if such original purchaser is a reseller or distributor of Seller's goods, such warranty shall also extend to any person or entity that purchases such goods directly from such reseller or distributor. There are no other warranties, express or implied, of any kind given with respect to the goods, their merchantability, fitness for any particular purpose or usage, or otherwise, nor is any person authorized to extend on behalf of Seller any form of warranty other than that above set forth. The goods described herein are not sold or distributed by Seller for personal, family or household purposes, nor are they normally suited for use as such.
- 2. Prices:** Prices and other terms of sale where set forth in current price sheets are subject to change without notice. Stenographic or clerical errors are subject to correction.
- 3. Acceptance of Orders and Assignment:** All orders are subject to acceptance by Seller at its home office, Stafford, Texas, only. No assignment of the Purchaser's rights or obligations under any purchase order may be made without the prior written consent of the Seller.
- 4. Terms, Payment and Partial Shipment:** All accounts are payable net 30 days from invoice date. Seller shall charge one percent (1%) per month interest charged on accounts after 30 days from invoice date, or twelve percent (12%) annually. All accounts are payable in United States dollars, free of exchange, collection, or any other charges. If in the sole discretion of Seller, the financial condition of the Purchaser at any time so requires, Seller retains the right to require full or partial payment in advance, to set spending limits for credit accounts or to require other adequate assurances of financial responsibility. Seller reserves the right to make partial shipments from time to time and render invoices therefore, which shall be due and payable as provided in said invoices.
- 5. Freight Charges:** Unless otherwise specifically noted, standard shipping charges (calculated by product weight, not including packaging) shall be added or be in addition to the price quoted and Purchaser agrees to pay the same to Seller.
- 6. Taxes:** Unless otherwise specifically noted, the amount of any sales, use, value added, occupancy, excise tax, or other tax, of any nature, federal, state, or local, for which Seller is legally liable, either initially or through failure of payment by Purchaser, shall be added or be in addition to the price quoted and Purchaser agrees to pay the same to Seller.
- 7. Unavoidable Conditions:** Seller shall not be liable for failure to deliver or delays in delivery occasioned by causes beyond its control, including, without limitation, strikes, lockouts, fires, embargoes, war or other outbreaks of hostilities, acts of God, inability to obtain shipping space, machinery, breakdowns, delays of carriers or suppliers, and governmental acts or regulations.
- 8. Returns and Cancellations:** Return requests must be made within 90 days of shipment, and no product may be returned without a prior written Returned Goods Authorization (RGA) form signed by Seller and freight prepaid by Purchaser. All standard materials returned are subject to a handling charge, freight in both directions, a 25% minimum restocking fee and charges for any required reconditioning, clean up or re-certification, unless otherwise specified in writing by Seller. All returned standard materials are subject to inspection and final disposition by Seller's quality department. Special material items, buyouts, and modified products are non-returnable. Overages, shortages and incorrect material claims must be made in writing within ten (10) days of receipt of goods. Cancellation of orders once placed with and accepted by Seller may be made only with its written consent. Cancellation of orders are subject to a cancellation charge to be determined by impact at time of cancellation or modification of order. Cancellation of non-standard material or excessive quantities as determined by Seller may incur up to 100% cancellation charge depending on stage of work in progress.
- 9. No Waiver:** Seller's failure to insist upon compliance with any of the terms, covenants, or conditions listed herein or to exercise any right hereunder shall not be construed as a waiver or relinquishment of the future performance of any such term, covenant or condition, or the future exercise of such right or a waiver or relinquishment or waiver of any other term, covenant or condition or the exercise of any other rights hereunder.
- 10. Drawings, Data and Confidential Information:** The weights, dimensions, capacities, prices, performance ratings and other data included in catalogues, prospectuses, circulars, advertisements, illustrated matter and price lists constitute a guide. These data shall not be binding except to the extent that they are by reference expressly included in the purchase order. Any drawings or technical documents intended for use in the manufacture or construction of machinery, equipment, plants, parts, or other material and any ancillary services associated therewith, or any part thereof, and submitted to the Purchaser prior or subsequent to the formation of the purchase order (the "Material"), remain the exclusive property of the Seller; provided however, that the Material shall become the property of the Purchaser only if the Purchaser and Seller agree in writing. The Material shall not, without the Seller's consent, be utilized by the Purchaser or copied, reproduced transmitted or communicated to an unauthorized third party.
- 11. Governing Law:** This contract shall be governed by, construed and enforced in accordance with the laws of the State of Texas, without regard to its conflicts of law rules that would apply the laws of any other jurisdiction.
- 12. Totality of Agreement, Special Provisions, Modifications, Severability:** These Terms and Conditions constitute the entire agreement of the parties with respect to all matters and things herein mentioned. Purchaser warrants, represents and agrees that it has inspected the goods and otherwise made inquiry and review, upon its own behalf, concerning the nature, characteristics and quality of the materials and workmanship incorporated therein at or prior to delivery, that it is fully contented and satisfied therewith and has independently determined that the goods are in all respects fit and usable for all purposes for which they are intended to be employed by Purchaser. It is expressly acknowledged and agreed by and between the parties that neither party has, nor is now, relying upon any collateral, prior or contemporaneous agreement, written or oral, assurance or assurances, representations or warranties, of any kind or nature as to or respecting the condition or capabilities of the goods and the other matters and things, rights and responsibilities herein fixed and described. No modification, waiver or discharge of any term or provision of these Terms and Conditions shall be implied by law, nor shall any alteration, modification or acquittance of any such term or provision be effective for any purpose unless signed in writing by or on behalf of the party charged therewith. All products are subject to prior sales. All sales are subject to these [Terms & Conditions](#).
- 13. Export Regulations:** Seller's products can only be exported in accordance with U.S. Export Administration Regulations and other U.S. legal requirements. Diversion contrary to U.S. law is prohibited.

Represented By:



12735 Dairy Ashford Road
Stafford, Texas 77477
281.340.5400
Toll Free: 800.256.6193
Fax: 281.340.5499
www.globalflowtech.com